



 Midea



MIDEA HEATING AND COOLING

**MULTI SPLIT**



Midea, established in 1968, is a public limited company. Since July 2016, it has been a Fortune 500 company, offering one of the most comprehensive ranges of products in the home appliances industry. Midea specializes in air treatment (both residential and commercial solutions), refrigeration, laundry, cooking appliances, small kitchen appliances, water appliances, floor care, and lighting.

## Midea is My True Blue Idea

Our objective is to deliver the best home solutions for every Australia family. Our home solutions are inspired by the ideas and needs of our Australian guests. Therefore, we created the slogan “Midea is My True Blue Idea”.

## Midea Appliances Australia

Established in 2018 as MD Appliances Pty Ltd, we are dedicated to establishing a successful Midea air conditioning story in Australia by maintaining high standards of performance and customer satisfaction.



### 7 years parts and labor warranty

For Residential Products  
Online Registration T&C Apply



### 5 years parts and labor warranty

For Commercial Products



### 2 years parts and labor warranty

For Heavy Commercial Products



### Local after sales service and support

\* Source Euromonitor International (Shanghai) Limited; Consumer Appliances 23ed, retail volume sales in unit, 2022 data

# Our Technology:

## THE EXCLUSIVE INVERTER QUATTRO™ TECHNOLOGY



A brain that calculates your needs in any conditions

Midea's Genius Core Energy Chip with Precise-control Inverter Deduction Algorithm reduces energy loss by enabling more precise signal reception, accurate data processing, and prompt delivery of instructions to the compressor. As a result, Midea's inverter compressor offers more stable operation than common inverters. It's super-smooth inverter frequency of variation ensures you never notice fluctuations in room temperature.

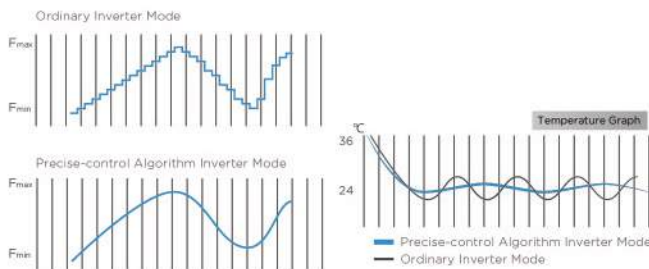

Up to **71%**  
Ultra Energy Saving

65Hz in **6** seconds  
Flash Cooling/Heating

Within **±0.5°C**  
Comfort With Stable Temperature

Superior operation from **60 to -30°C**  
High Ambient Cooling/Heating

## FULL DC INVERTER SYSTEM

Thanks to the Full DC Inverter System, Midea's air conditioners achieved 20% higher **energy efficiency compared to** normal AC inverters.

On top of the Midea's Full DC Inverter System, the Genius Core is an intelligent commander that keeping the harmony internally and externally



**Sine-wave DC inverter control**



**Rear-earth magnet motor**



**IPM DC Fan Motor**

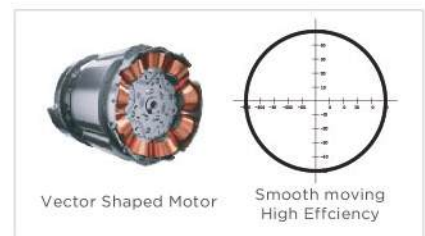

Vector Shaped Motor

Smooth moving High Efficiency

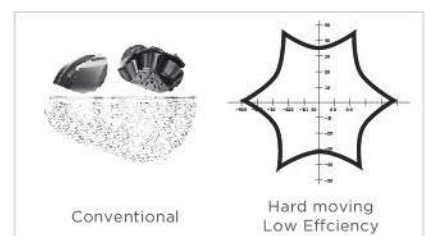

Conventional

Hard moving Low Efficiency

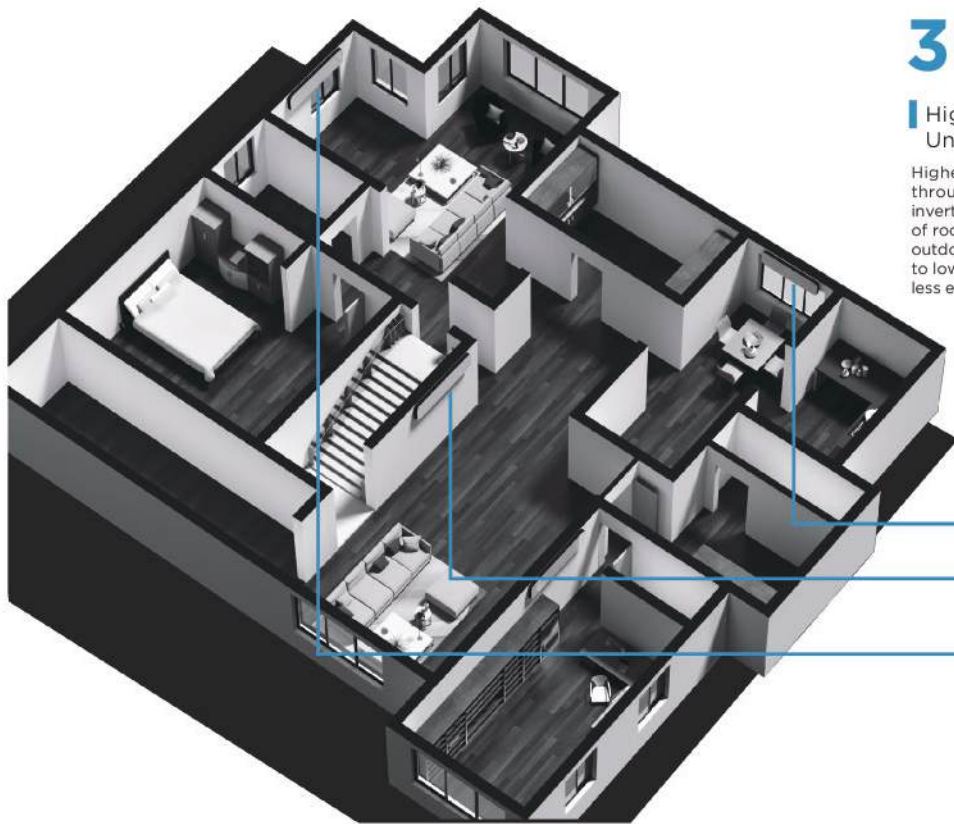

# 30%

## Higher Energy Efficiency Under Partial load

Higher efficiency can be achieved through partial output mode of the inverter compressor. In situations only a part of rooms that need air conditioning, the outdoor unit will run with partial output to lower the power consumption. Up to 30% less energy use under partial load



## Bionic Blower Wheel and Improved Air Duct

Based on natural models and bionic principles, Midea's fan blade design can effectively reduce airflow resistance and noise. Together with the optimized air duct, it delivers the same air flow volume with 30% less energy consumption.

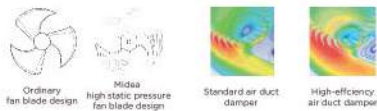

## V-PAM (Vector + I-PAM) Inverter Control

V-PAM inverter control reduces the effects of magnetic flux and increases the maximum speed and efficiency of the compressor by vector control technology. With this technology, further miniaturization, higher efficiency, and better performance are attained.

Full DC Inverter Control



## Twin-Rotary Compressor

The Twin-Rolling compressor system rotating with 180° symmetrical balance ensures low vibration & noise due to the small torque

MULMI0371B, MULMI0480B,  
MULMI0513B, MULMI0618B

## Inner Groove-Tube

A densely serrated shape has been applied to the copper to enlarge the heat exchange area. The latest heat exchanger has increased the tooth-count from 45 to 54, further improving the efficiency of heat transfer.

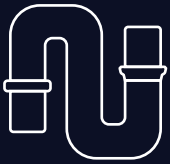

# AUTOMATIC WIRING/PIPING CORRECTION

Midea multi-split unit helps the technicians to easily finish the wiring and piping. It saves great efforts by automatically correcting the connection and avoids any trial operations of every indoor unit after installation. The technicians press “check switch”, wait for few minutes and the machine will begin to operate as expected.

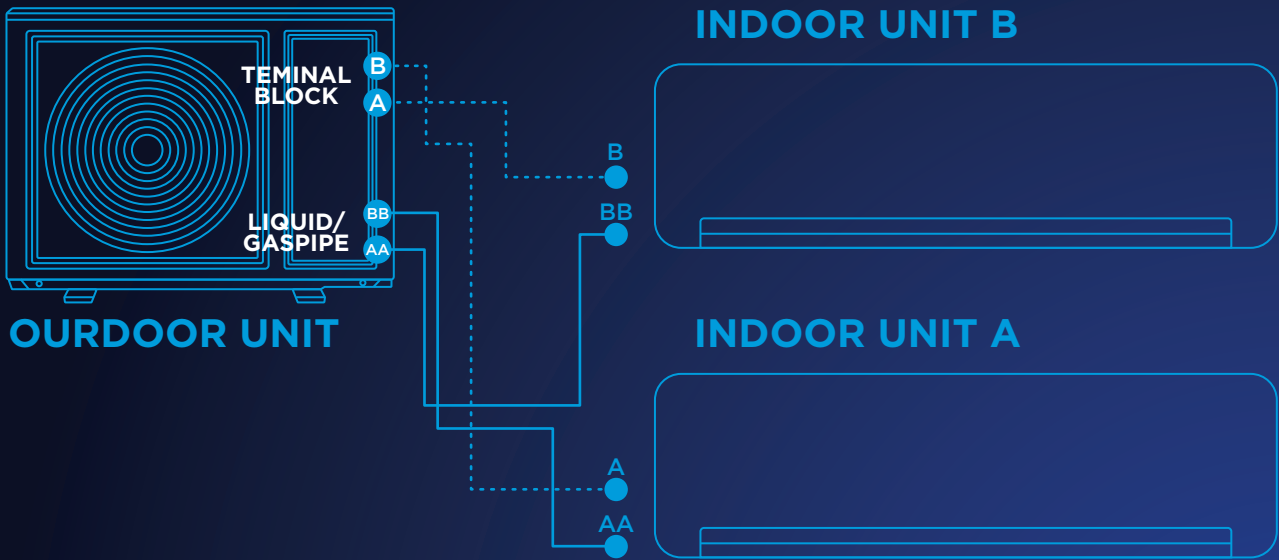

MULTI-SPLIT UNIT - THE RIGHT AIR SOLUTION FOR MULTIPLE SPACE

## BEFORE

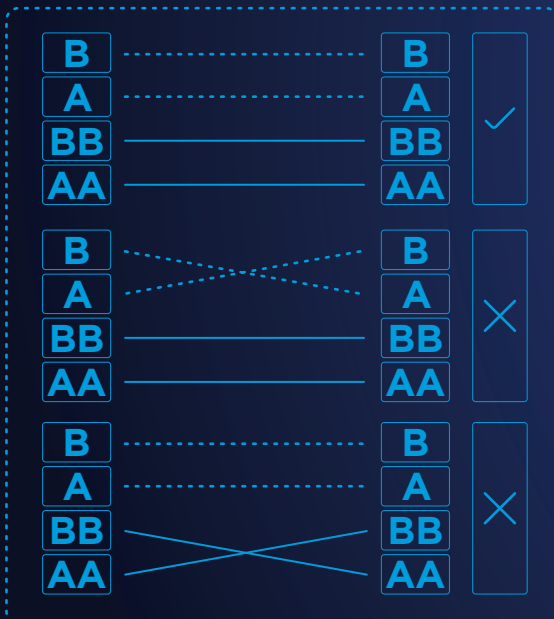

## NOW

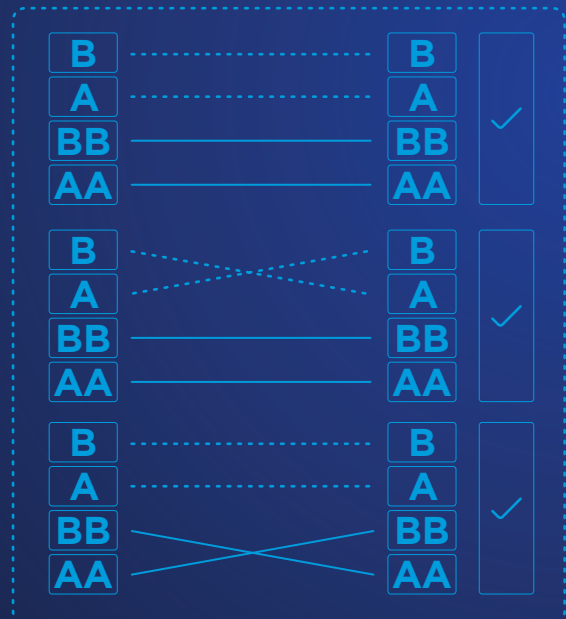



## MULTI ODU



Multi ODU	Cooling Capacity (kW)	Heating Capacity (kW)	Max. IDU amounts
MULMI0250B	5.25 (0.9 - 5.7)	5.5 (1.9 - 5.7)	Up to 2 units
MULMI0371B	7.05 (1.71 - 9.01)	7.3 (1.78 - 9.41)	Up to 3 units
MULMI0408B	8.0 (3.28 - 10.08)	8.5 (2.49 - 10.40)	Up to 4 units
MULMI0513B	13.5 (1.71 - 16.75)	14.8 (1.78 - 18.15)	Up to 5 units
MULMI0618B	18.0 (4.57 - 18.5)	20.5 (4.98-20.7)	Up to 6 units

# WIRELESS CONTROLLER

## WIRELESS CONTROLLER FEATURE LIST



- \* Comes in the box for all split systems.
- \* Optional for all cassettes and ducted systems.  
(To use a wireless controller, a ducted system will require a wired controller as a signal receiver.)

Temperature range	16-30°C 62-86°F
Backlight	√
Press Button	√
ON/OFF	√
Mode	√
Temp Adjustment	√
Fanspeed	√
Turbo	√
Follow Me	√
Timer ON/OFF	√
Child Lock	√
Dry	√
Setting Temp Limit	√

# MULTI SPLIT OUTDOOR



Model Number			MULMI0250B	MULMI0371B	MULMI0480B	
Power supply		Ph-V-Hz	220-240-1-50	220-240-1-50	220-240-1-50	
Cooling	Capacity (indoor+Outdoor)*	kW	5.25	7.1	8.0	
	Power Input (indoor+Outdoor)	kW	1.3	1.95	2.0	
	Rated current (Indoor+Outdoor)	A	6.81	8.68	9.15	
	EER (Indoor+Outdoor)*	W/W	4.03	3.64	4.00	
Heating	Capacity (Indoor+Outdoor)*	kW	5.5	7.5	8.5	
	Power input (indoor+Outdoor)*	kW	1.16	1.64	1.93	
	Rated current (indoor+Outdoor)*	A	6.65	7.51	8.83	
	COP (Indoor+Outdoor)	W/W	4.74	4.57	4.40	
Max.current		A	12	17.5	19.0	
Outdoor unit	Dimension(H*W*D)	mm	805x330x554	890x342x673	946x410x810	
	Packing(H*W*D)	mm	915x370x615	1030x438x750	1090x500x875	
	Net/Gross weight	Kg	34.6/37.7	48.1/51.6	66.2/71.6	
Refrigerant	Type		R32	R32	R32	
	Pre-charged length for all indoor to outdoor	m	15	22.5	30	
Refrigerant piping	Liquid side		2 x Ø6.35(1/4")	3 x Ø6.35(1/4")	4 x Ø6.35(1/4")	
	Gas side		2 x Ø9.52(3/8")	3 x Ø9.52(3/8")	3 x Ø9.52(3/8") + 1 x Ø--12.7(1/2")	
	Max. length for all rooms	m	40	60	80	
	Max.length for one indoor unit	m	25	30	35	
	Min. length for one indoor unit	m	6	9	12	
	Max. height difference(m)	OU to IU		15	15	15
		IU to IU		10	10	10

Model Number			MULMI0513B	MULMI0618B	
Power supply		Ph-V-Hz	220-240-1-50	220-240-1-50	
Cooling	Capacity (indoor+Outdoor)*	kW	13.5	18.0	
	Power Input (indoor+Outdoor)	kW	3.73	5.1	
	Rated current (Indoor+Outdoor)	A	17.8	22.8	
	EER (Indoor+Outdoor)*	W/W	3.62	3.53	
Heating	Capacity (Indoor+Outdoor)*	kW	14.0	20.5	
	Power input (indoor+Outdoor)*	kW	3.15	5.0	
	Rated current (indoor+Outdoor)*	A	16.2	24.0	
	COP (Indoor+Outdoor)	W/W	4.44	4.10	
Max.current		A	30	33	
Outdoor unit	Dimension(H*W*D)	mm	980x415x975	952x415x1333	
	Packing(H*W*D)	mm	1145x500x1080	1095x495x1480	
	Net/Gross weight	Kg	91/106.4	110.6/124.9	
Refrigerant	Type		R32	R32	
	Pre-charged length for all indoor to outdoor	m	37.5	45	
Refrigerant piping	Liquid side		5 x Ø6.35(5x1/4")	6 x Ø6.35(1/4")	
	Gas side		3 x Ø9.52 + 2 x Ø12.7(3x3/8" + 2 x 1/2")	4 x Ø9.52(3/8") + 2 x Ø12.7(1/2")	
	Max. length for all rooms	m	80	80	
	Max.length for one indoor unit	m	35	35	
	Min. length for one indoor unit	m	15	15	
	Max. height difference(m)	OU to IU		15	15
		IU to IU		10	10



# MULTI SPLIT HIGH WALLS



Venus

Model Number			MFAG20VA-N	MFAG26VA-N	MFAG36VA-N	MFAG51VA-N
Power supply		Ph-V-Hz	220-240V1Ph,50Hz	220-240V1Ph,50Hz	220-240V1Ph,50Hz	220-240V1Ph,50Hz
Rated Cooling	Capacity	kW	2.00	2.60	3.55	5.00
Rated Heating	Capacity	kw	2.25	2.70	3.80	5.52
Indoor air flow(Turbo/Hi/Mi/Lo/Silence)		m3/h	550/460/340/270	550/460/340/270	660/530/380/310	950/800/600/500
Indoor noise evel/ (Turbo/Hi/Mi/Lo/Silence)(sound pressure)		dB(A)	43.0/38/31.5/30/25	46.4/39/32.5/30/24.5	46.7/39/32.5/30/24.5	471/44.5/38/34.5/28
Indoor noise level(sound power)		dB(A)	53	55	56	59
Indoor unit	Dimenson(W"D'H)	mm	729x200x292	729x200x292	802x200x295	971x228x321
	Packing (W'D'H)	mm	790x270x375	790x270x375	875x285x380	1045x305x405
	Net/Gross weight	Kg	8.0/10.3	8.0/10.3	8.5/11.1	11./14.4
Refrigerant piping	Liquid side/ Gas side	mm(inch)	6.35mm(1/4in) /9.52mm(3/8in)	6.35mm(1/4in) /9.52mm(3/8in)	6.35mm(1/4in) /9.52mm(3/8in)	6.35mm(1/4in) /12.7mm(1/2in)

Model Number			MFAG60VA-N	MFAG70VA-N	MFAG80VA-N
Power supply		Ph-V-Hz	220-240V1Ph,50Hz	220-240V1Ph,50Hz	220-240V1Ph,50Hz
Rated Cooling	Capacity	kW	6.00	7.00	8.00
Rated Heating	Capacity	kw	6.20	7.50	8.50
Indoor air flow(Turbo/Hi/Mi/Lo/Silence)		m3/h	950/800/600/500	1375/1205/844/670	1375/1205/844/670
Indoor noise evel/ (Turbo/Hi/Mi/Lo/Silence)(sound pressure)		dB(A)	471/44.5/38/34.5/28	576/45/39/33.5/29.5	576/45/39/33.5/29.5
Indoor noise level(sound power)		dB(A)	59	61	61
Indoor unit	Dimenson(W"D'H)	mm	971x228x321	1082x234x337	1082x234x337
	Packing (W'D'H)	mm	1045x305x405	1155x415x315	1155x415x315
	Net/Gross weight	Kg	11./14.4	13.5/17.1	13.5/17.1
Refrigerant piping	Liquid side/ Gas side	mm(inch)	6.35mm(1/4in) /12.7mm(1/2in)	6.35mm(1/4in) /15.9mm(5/8in)	6.35mm(1/4in) /15.9mm(5/8in)

# DUCTED CONNECTED



MULMID09B  
MULMID12B  
MULMID18B  
MULMID24B

Model Number			MULMID09B	MULMID12B
Cooling	Capacity	kW	2.6	3.5
Heating	Capacity	kW	2.9	3.8
Indoor air flow		m <sup>3</sup> /h	500/340/230	600/480/300
External Static	Rated	Pa	25	25
Pressure	Range	Pa	0-40	0-60
Indoor noise level (Hi/Mi/Lo)		dB(A)	40/34.5/27.5	34.5/32/30
Indoor unit	Dimension (H*W*D)	mm	200x700x450	200x700x506
	Packing (H*W*D)	mm	275x860x540	285x860x540
	Net / Gross weight	Kg	18/22	17.8/21.5
Design pressure		MPa	4.3/1.7	4.3/1.7
Drainage water pipe diameter		mm	OD Ø25	OD Ø25
Refrigerant piping	Liquid side / Gas side	mm	Ø6.35 / Ø9.52(1/4"/3/8")	Ø6.35 / Ø9.52(1/4"/3/8")
Standard Thermostat type			Remote control	Remote control

Model Number			MULMID18B	MULMID24B
Cooling	Capacity	kW	5	7
Heating	Capacity	kW	5.5	7.6
Indoor air flow		m <sup>3</sup> /h	911/706.3/515.2	1229/1035/825
External Static	Rated	Pa	25	25
Pressure	Range	Pa	0-100	0-160
Indoor noise level (Hi/Mi/Lo)		dB(A)	42/39/35	49/46/41
Indoor unit	Dimension (H*W*D)	mm	210x880x674	249x1100x774
	Packing (H*W*D)	mm	280x1070x725	315x1305x805
	Net / Gross weight	Kg	24.4/29.6	32.3/39.1
Design pressure		MPa	4.3/1.7	4.3/1.7
Drainage water pipe diameter		mm	OD Ø25	OD Ø25
Refrigerant piping	Liquid side / Gas side	mm	Ø6.35 / Ø12.7(1/4"/1/2")	Ø9.52 / Ø15.9(3/8"/5/8")
Standard Thermostat type			Remote control	Remote control

# COMPACT CASSETTE



MULMIC07B  
MULMIC09B  
MULMIC12B  
MULMIC18B

Model Number			MULMIC07B	MULMIC09B
Cooling	Capacity	kW	2.0	2.6
Heating	Capacity	kW	2.35	2.93
Indoor air flow		m <sup>3</sup> /h	580/500/450	580/500/450
Indoor noise level (Hi/Mi/Lo)		dB(A)	38/33/29	38/33/29
Indoor unit	Dimension (H*W*D)	mm	260x570x570	260x570x570
	Packing (H*W*D)	mm	317x662x662	317x662x662
	Net / Gross weight	Kg	14.5/17.3	14.5/17.3
Design pressure		MPa	4.6/1.7	4.6/1.7
Drainage water pipe diameter		mm	OD Ø25	OD Ø25
Refrigerant piping	Liquid side / Gas side	mm	Ø6.35 / Ø9.52(1/4"/3/8")	Ø6.35 / Ø9.52(1/4"/3/8")
Standard Thermostat type			Remote control	Remote control

Model Number			MULMIC12B	MULMIC18B
Cooling	Capacity	kW	3.5	5.0
Heating	Capacity	kW	4.1	5.42
Indoor air flow		m <sup>3</sup> /h	617/504/415	680/560/500
Indoor noise level (Hi/Mi/Lo)		dB(A)	41/37/34	44/42/41
Indoor unit	Dimension (H*W*D)	mm	260x570x570	260x570x570
	Packing (H*W*D)	mm	317x662x662	317x662x662
	Net / Gross weight	Kg	16.2/21.4	16.2/21.4
Design pressure		MPa	4.2/1.5	4.3/1.7
Drainage water pipe diameter		mm	OD Ø25	OD Ø25
Refrigerant piping	Liquid side / Gas side	mm	Ø6.35 / Ø9.52(1/4"/3/8")	Ø6.35 / Ø12.7(1/4"/1/2")
Standard Thermostat type			Remote control	Remote control

# ONE WAY CASSETTE



MULMIO09  
MULMIO12  
MULMIO18

Model Number			MULMIO09	MULMIO12	MULMIO18
Power supply		Ph-V-Hz	220-240V-1Ph-50Hz	220-240V-1Ph-50Hz	220-240V-1Ph-50Hz
Rated Cooling	Capacity	kW	2.76	3.60	5.00
Rated Heating	Capacity	kW	2.90	3.90	5.20
Indoor air flow (Turbo/Hi/Mi/Lo/Silence)		m <sup>3</sup> /h	188/166/141/97	188/166/141/97	188/166/141/97
Indoor noise level / (Turbo/Hi/Mi/Lo/Silence) (sound pressure)		dB(A)	43/40/36/27	43/40/36/27	43/40/36/27
Outdoor sound pressure level		dB(A)	60	60	60
Indoor unit	Dimension (H*W*D)	mm	1278x335x228	1278x335x228	1278x335x228
	Packing (H*W*D)	mm	1463x571x575	1463x571x575	1463x571x575
	Net / Gross weight	Kg	20.1/35.8	20.1/35.8	20.1/35.8
Refrigerant piping	Liquid side / Gas side	mm(inch)	6.35mm(1/4") / 12.7mm(1/2")	6.35mm(1/4") / 12.7mm(1/2")	6.35mm(1/4") / 12.7mm(1/2")

# INDOOR UNITS COMBINATION

## INDOOR UNITS COMBINATION MULMI0250B

One Unit (kW)	Two Unit (kW)	
3.5	2.0+2.0	2.6+2.6
5.3	2.0+2.6	2.6+3.5
/	2.0+3.5	3.5+3.5

## INDOOR UNITS COMBINATION MULMI0371B

One Unit (kW)	Two Unit (kW)			Two Unit (kW)		
5.3	2.0+2.0	2.6+2.6	3.5+5.3	2.0+2.0+2.0	2.0+2.6+2.6	2.0+2.0+5.3
6.0	2.0+2.6	2.6+3.5	2.0+5.3	2.0+2.0+2.6	2.0+2.6+3.5	2.0+2.6+5.3
/	2.0+3.5	2.6+5.3	3.5+6.0	2.0+2.0+3.5	2.6+2.6+3.5	2.0+2.0+6.0
/	2.0+5.3	3.5+3.5	2.0+6.0	2.0+2.0+5.3	2.0+3.5+3.5	2.0+2.6+6.0
/	2.0+6.0	2.6+6.0	/	2.0+2.0+6.0	/	/

## INDOOR UNITS COMBINATION MULMI0480B

One Unit (kW)	Two Unit (kW)				Three Unit (kW)				
7.1	2.0+2.0	2.6+2.6	3.5+5.3	2.0+7.1	2.0+2.0+2.0	2.0+2.6+2.6	2.0+3.5+5.3	2.6+3.5+5.3	2.6+3.5+5.3
8.0	2.0+2.6	2.6+3.5	3.5+7.1	2.0+8.0	2.0+2.0+2.6	2.0+2.6+3.5	2.6+2.6+2.6	3.5+3.5+3.5	3.5+3.5+5.3
/	2.0+3.5	2.6+5.3	5.3+5.3	3.5+8.0	2.0+2.0+3.5	2.0+2.6+5.3	2.6+2.6+3.5	2.6+3.5+3.5	2.6+3.5+7.1
/	2.0+5.3	3.5+3.5	2.6+7.1	6.0+6.0	2.0+2.0+5.3	2.0+3.5+3.5	2.6+2.6+5.3	2.0+2.0+7.1	3.5+3.5+7.1
/	2.0+6.0	2.6+6.0	3.5+6.0	2.6+8.0	2.0+2.0+6.0	2.0+2.6+6.0	2.0+3.5+6.0	2.6+3.5+6.0	2.6+3.5+8.0
/	/	/	/	/	2.6+3.5+6.0	3.5+3.5+6.0	2.6+2.6+6.0	2.0+2.0+8.0	3.5+3.5+8.0

Four Unit (kW)				
2.0+2.0+2.0+2.0	2.0+2.0+2.6+2.6	2.0+2.6+2.6+3.5	2.0+2.0+2.0+5.3	2.6+2.6+3.5+5.3
2.0+2.0+2.0+2.6	2.0+2.0+2.6+3.5	2.6+2.6+2.6+2.6	2.0+2.0+2.6+5.3	2.0+2.0+2.0+7.1
2.0+2.0+2.0+3.5	2.0+2.0+2.6+5.3	2.6+2.6+2.6+3.5	2.0+2.6+2.6+5.3	2.0+2.0+2.6+7.1
2.0+2.0+2.0+5.3	2.0+2.0+3.5+3.5	2.0+2.6+2.6+2.6	2.6+2.6+2.6+5.3	2.6+2.6+3.5+6.0
2.0+2.0+2.0+6.0	2.0+2.0+2.6+6.0	2.0+2.0+2.0+6.0	2.0+2.0+2.6+6.0	2.0+2.0+2.0+8.0
2.0+2.6+2.6+6.0	2.6+2.6+2.6+6.0	2.0+2.0+2.6+8.0	/	/

# INDOOR UNITS COMBINATION MULMI0513B

One Unit (kW)	Two Unit (kW)			Three Unit (kW)				
7.1	2.0+2.0	2.6+2.6	3.5+5.3	2.0+2.0+2.0	2.0+2.6+2.6	2.0+3.5+5.3	2.6+2.6+5.3	2.6+5.3+5.3
8.0	2.0+2.6	2.6+3.5	3.5+7.1	2.0+2.0+2.6	2.0+2.6+3.5	2.0+3.5+7.1	2.6+2.6+7.1	3.5+3.5+3.5
/	2.0+3.5	2.6+5.3	5.3+5.3	2.0+2.0+3.5	2.0+2.6+5.3	2.0+5.3+5.3	2.6+3.5+3.5	3.5+3.5+5.3
/	2.0+5.3	2.6+7.1	5.3+7.1	2.0+2.0+5.3	2.0+2.6+7.1	2.6+2.6+2.6	2.6+3.5+5.3	3.5+3.5+7.1
/	2.0+7.1	3.5+3.5	3.5+6.0	2.0+2.0+7.1	2.0+3.5+3.5	2.6+2.6+3.5	2.6+3.5+7.1	3.5+5.3+5.3
/	2.0+6.0	2.6+6.0	3.5+8.0	2.0+2.0+6.0	2.0+2.6+6.0	2.0+3.5+6.0	2.6+2.6+6.0	3.5+3.5+6.0
/	2.0+8.0	2.6+8.0	6.0+6.0	2.0+2.0+8.0	2.0+2.6+8.0	2.0+3.5+8.0	2.6+2.6+8.0	3.5+3.5+8.0
/	/	/	6.0+8.0	2.6+6.0+6.0	2.6+3.5+8.0	2.0+6.0+6.0	2.6+3.5+6.0	3.5+6.0+6.0

Four Unit (kW)						
2.0+2.0+2.0+2.0	2.0+2.0+2.6+2.6	2.0+2.0+3.5+5.3	2.0+2.6+2.6+5.3	2.0+2.6+5.3+5.3	2.6+2.6+2.6+3.5	2.6+2.6+3.5+7.1
2.0+2.0+2.0+2.6	2.0+2.0+2.6+3.5	2.0+2.0+3.5+7.1	2.0+2.6+2.6+7.1	2.0+3.5+3.5+3.5	2.6+2.6+2.6+5.3	2.6+3.5+3.5+3.5
2.0+2.0+2.0+3.5	2.0+2.0+2.6+5.3	2.0+2.0+5.3+5.3	2.0+2.6+3.5+3.5	2.0+3.5+3.5+5.3	2.6+2.6+2.6+7.1	2.6+3.5+3.5+5.3
2.0+2.0+2.0+5.3	2.0+2.0+2.6+7.1	2.0+2.6+2.6+2.6	2.0+2.6+3.5+5.3	2.0+3.5+3.5+7.1	2.6+2.6+3.5+3.5	3.5+3.5+3.5+3.5
2.0+2.0+2.0+7.1	2.0+2.0+3.5+3.5	2.0+2.6+2.6+3.5	2.0+2.6+3.5+7.1	2.6+2.6+2.6+2.6	2.6+2.6+3.5+5.3	3.5+3.5+3.5+5.3
2.0+3.5+5.3+5.3	2.6+2.6+5.3+5.3	2.6+3.5+3.5+7.1	3.5+3.5+3.5+7.1	2.6+3.5+3.5+8.0	2.0+2.6+3.5+8.0	3.5+3.5+3.5+8.0
2.0+2.0+2.0+6.0	2.0+2.0+2.6+6.0	2.0+2.0+3.5+6.0	2.0+2.6+2.6+6.0	2.0+2.6+6.0+6.0	2.6+2.6+2.6+6.0	2.6+2.6+3.5+8.0
2.0+2.0+2.0+8.0	2.0+2.0+2.6+8.0	2.0+2.0+3.5+8.0	2.0+2.6+2.6+8.0	2.0+3.5+3.5+6.0	2.6+2.6+2.6+8.0	2.6+3.5+3.5+6.0
2.0+3.5+6.0+6.0	2.6+2.6+6.0+6.0	2.0+2.0+6.0+6.0	2.0+2.6+3.5+6.0	2.0+3.5+3.5+8.0	2.6+2.6+3.5+6.0	3.5+3.5+3.5+6.0

Five Unit (kW)				
2.0+2.0+2.0+2.0+2.0	2.0+2.0+2.0+2.6+2.6	2.0+2.0+2.6+2.6+2.6	2.0+2.6+2.6+2.6+2.6	2.0+2.6+3.5+3.5+3.5
2.0+2.0+2.0+2.0+2.6	2.0+2.0+2.0+2.6+3.5	2.0+2.0+2.6+2.6+3.5	2.0+2.6+2.6+2.6+3.5	2.0+2.6+3.5+3.5+5.3
2.0+2.0+2.0+2.0+3.5	2.0+2.0+2.0+2.6+5.3	2.0+2.0+2.6+2.6+5.3	2.0+2.6+2.6+2.6+5.3	2.0+2.0+3.5+3.5+3.5
2.0+2.0+2.0+2.0+5.3	2.0+2.0+2.0+2.6+7.1	2.0+2.0+2.6+2.6+7.1	2.0+2.6+2.6+2.6+7.1	2.0+2.0+3.5+3.5+5.3
2.0+2.0+2.0+2.0+7.1	2.0+2.0+2.0+3.5+3.5	2.0+2.0+2.6+3.5+3.5	2.0+2.6+2.6+3.5+3.5	2.0+2.0+3.5+3.5+7.1
2.0+2.0+2.0+3.5+7.1	2.0+2.0+2.0+3.5+5.3	2.0+2.0+2.6+3.5+5.3	2.0+2.6+2.6+3.5+5.3	2.6+2.6+2.6+3.5+5.3
2.0+2.0+2.0+2.0+6.0	2.0+2.0+2.0+2.6+6.0	2.0+2.0+2.6+2.6+6.0	2.0+2.6+2.6+2.6+6.0	2.0+2.6+3.5+3.5+6.0
2.0+2.0+2.0+2.0+8.0	2.0+2.0+2.0+2.6+8.0	2.0+2.0+2.6+2.6+8.0	2.0+2.6+2.6+2.6+8.0	2.0+2.0+3.5+3.5+6.0
2.0+2.0+2.0+3.5+8.0	2.0+2.0+2.0+3.5+6.0	2.0+2.0+2.6+3.5+6.0	2.0+2.6+2.6+3.5+6.0	2.0+2.0+3.5+3.5+8.0

Five Unit (kW)			
2.0+2.0+2.0+5.3+5.3	2.0+3.5+3.5+3.5+3.5	2.6+2.6+2.6+2.6+2.6	2.6+2.6+3.5+3.5+3.5
2.0+2.0+2.0+5.3+7.1	2.0+3.5+3.5+3.5+5.3	2.6+2.6+2.6+2.6+3.5	2.6+2.6+3.5+3.5+5.3
2.0+2.0+2.6+3.5+7.1	2.6+2.6+2.6+2.6+5.3	2.6+2.6+2.6+3.5+7.1	2.6+2.6+3.5+3.5+7.1
2.0+2.6+2.6+3.5+7.1	2.6+2.6+2.6+2.6+7.1	2.6+3.5+3.5+3.5+3.5	3.5+3.5+3.5+3.5+3.5
2.0+2.6+3.5+3.5+7.1	2.6+2.6+2.6+3.5+3.5	2.6+3.5+3.5+3.5+5.3	3.5+3.5+3.5+3.5+5.3
2.0+2.0+2.0+6.0+6.0	2.0+3.5+3.5+3.5+6.0	2.6+2.6+2.6+3.5+8.0	2.6+2.6+3.5+3.5+6.0
2.0+2.0+2.0+6.0+8.0	2.6+2.6+2.6+2.6+6.0	2.6+3.5+3.5+3.5+6.0	2.6+2.6+3.5+3.5+8.0
2.0+2.0+2.6+3.5+8.0	2.6+2.6+2.6+2.6+8.0	2.0+2.6+3.5+3.5+8.0	3.5+3.5+3.5+3.5+6.0
2.0+2.6+2.6+3.5+8.0	2.6+2.6+2.6+3.5+6.0	/	/



# World's No.1 Residential Inverter Air Conditioner Company

## World's No.1 Air Treatment Brand For 4 Consecutive Years

---



<sup>1</sup>Data source: Euromonitor International (Shanghai) Limited; Consumer Appliances 24ed, retail volume sales in unit, 2020 to 2023 data.

<sup>2</sup>Data source: Euromonitor International (Shanghai) Ltd., measured in terms of total production volume of residential inverter air conditioners (including OEM brands) in 2022, based on research conducted in Jul 2023. Inverter air conditioners refer to air conditioners installed with variable-speed drives.

Midea Air Conditioner Australia  
MD APPLIANCES PTY LTD  
**Address:** 7 Ordish Rd, Dandenong South VIC 3175  
**Phone:** 1300 726 002  
**Website:** MDHOME.COM.AU